

ALABAMA CHAPTER

AMERICAN COLLEGE OF EMERGENCY PHYSICIANS

POST OFFICE BOX 1265
DOTHAN, AL 36302

(334) 793-7270
1-877-2AL-ACEP
FAX (334) 671-1685

SOUTHEASTERN CHAPTERS (SEC) ACEP
ALABAMA, TENNESSEE, LOUISIANA, MISSISSIPPI
ARKANSAS, KENTUCKY, and SOUTH CAROLINA
EDUCATIONAL CONFERENCE
JUNE 6 – 9, 2011

EXHIBITOR PROSPECTUS

The **Alabama** Chapter of ACEP is pleased to announce our 28th Annual Emergency Medicine Education Conference to be held at the beautiful **SANDESTIN GOLF AND BEACH RESORT in Destin, Florida**. We are excited that the **Tennessee** Chapter of ACEP will join us for a fifth straight year as co-sponsor and the **Louisiana** and **Mississippi** Chapters are back for their third year, **Arkansas** and **Kentucky** Chapters for their second year and joining us this year is the **South Carolina** Chapter! This will be a prestigious educational meeting for emergency physicians, nurses, administrators, recruiters, corporate suppliers and more. We are expecting at least 150 to 200 emergency practitioners plus emergency medicine residents from all of the SEC states to be in attendance.

We are extending an invitation to select companies who would benefit from meeting with these emergency medicine professionals. Your attendance at this meeting will offer you the opportunity to meet and converse with emergency physicians and nurses from throughout the southeast.

This year the exhibits will be located in the hall outside the lecture room, down the hall toward the Bayview Room and inside the Bayview Room. Please refer to the enclosed diagram and mark your preferred booth slot for #1 choice through #5 choice. Choices will be assigned on first paid (check, credit card, or purchase order), first served basis and we will make every effort to put you as close to your choice as possible. Refreshments/breaks will be placed inside the Bayview Room (refer to diagram) to guarantee exposure to all exhibitors during the scheduled breaks. However, since we do not have the ability to lock the hallways, we will not be able to secure your valuables when you are not manning your exhibit. We will provide a room (Grand Ballroom A that is marked as Exhibitor Storage) that you can place your valuables in at 12:30 p.m. each day that will be locked until 6:00 a.m. the next morning.

Exhibitors may begin set up on Sunday, June 5, 2011 at 5:00 p.m. If you plan on setting up on Sunday, please note that the time is from 5:00 p.m. – 7:00 p.m. A sign will be placed on you booth assignment table that will have your company name when you arrive to set up. Any changes must have prior approval by an ACEP staff member.

The exhibit area will be open as follows:

Sunday	June 5	5:00 pm – 7:00 p.m.	Set up
Monday	June 6	6:30 am – 12:30 pm	Exhibit hours
Tuesday	June 7	6:30 am – 12:30 pm	Exhibit hours
Wednesday	June 8	6:30 am – 12:30 pm	Exhibit hours
Wednesday	June 8	5:00 pm - 7:00 pm	*Exhibitor Wine Reception
Thursday	June 9	6:30 am – 10:30 am	Exhibit hours

CONFERENCE REGISTRATION AND BREAKS WILL BE HELD NEAR THE EXHIBIT AREA.

Date: June 6 – 9, 2011
 Location: Sandestin Golf and Beach Resort, Linkside Conference Center
 Exhibitor Cost: \$800.00 -Participation for 2 representatives. Please include \$50.00 each/additional representatives. Shipping & Handling Guide and Electrical/Telephone Service information and forms are included and also located on our website at www.alacep.org
 *If you wish to participate in the Exhibitor Wine Reception, please include an additional \$100
 Sponsor Cost: See attached page
 Contact: Denise Louthain, Executive Director
 Dr. David Garvey, Chair, Education Committee
 (334) 793-7270 or 1-877-225-2237

SOUTHEASTERN CHAPTERS ACEP EDUCATION CONFERENCE
ALABAMA, TENNESSEE, LOUISIANA, MISSISSIPPI, ARKANSAS, KENTUCKY & SOUTH CAROLINA
JUNE 6 – 9, 2011
SANDESTIN GOLF AND BEACH RESORT
SANDESTIN, FLORIDA
EXHIBITOR REGISTRATION FORM

Name of Company _____

Contact Person: _____

Address: _____

City: _____ State: _____ Zip: _____ Telephone: _____

E-mail Address: _____ Company Website Address: _____

Name/Title and Address of Representative(s) Attending Conference

1. _____ 2. _____

_____ Exhibitor/Booth Fee (\$800) Participation for 2 representatives. \$50.00 each additional representatives to cover food for breaks & Welcome Reception.

Choice of exhibit spaces in order of preference: _____

_____ Participation in Wine Tasting at Exhibitor Reception (\$100)

In addition to Exhibit/Booth Space, we would like to purchase and support:

_____ PLATINUM LEVEL: Unrestricted Educational Grant: \$4100

_____ GOLD LEVEL: Unrestricted Educational Grant: \$2600

_____ SILVER LEVEL: Unrestricted Educational Grant: \$1100

_____ Golf Tournament Supporter (\$1500)

_____ Supporter of a Hole during the tournament (\$200/each)

_____ Welcome Reception Supporter (\$1500)

_____ Continental Breakfast Supporter (four available @ \$750 each)

_____ Mid-Morning Break Supporter (four available @ \$350 each)

_____ Supporter of Residents Poster Session (\$1000 – covers travel for 2 residents)

Complete, return, and include payment to Alabama ACEP Educational Conference:

Alabama ACEP
Attention: SEC Conference
P. O. Box 1265
Dothan, AL 36302

Telephone: (334) 793-7270
1-877-225-2237
Fax: (334) 671-1685
E-mail: dlouthain@alacep.org

NO CANCELLATION REFUNDS AFTER MAY 23, 2011. PRIOR TO MAY 23 THERE WILL BE A \$100.00 ADMINISTRATIVE FEE FOR CANCELLATIONS.

We do accept credit cards: _____ VISA _____ MC _____ AMEX (CHECK ONE)

Card Number _____ Expiration Date _____

V-Code _____ (Last three digits on signature strip on card)

Name as appears on credit card: _____

Signature: _____ (to authorize use)

SOUTHEASTERN CHAPTERS ACEP EDUCATION CONFERENCE
ALABAMA, TENNESSEE, LOUISIANA, MISSISSIPPI, ARKANSAS, KENTUCKY & SOUTH CAROLINA
JUNE 6 – 9, 2011
SANDESTIN GOLF AND BEACH RESORT, SANDESTIN, FLORIDA

SUPPORTER LEVELS

PLATINUM LEVEL: Unrestricted Educational Patron: \$4100

- ❖ Listed as distinguished "Platinum Level Patron" in conference packet.
- ❖ Prime location in exhibit area with additional space.
- ❖ Company name posted on marquis as "Platinum Level Patron" throughout conference activities.
- ❖ Verbal recognition during general session.

GOLD LEVEL: Unrestricted Educational Patron: \$2600

- ❖ Listed as distinguished "Gold Level Patron" in conference packet.
- ❖ Prime location in exhibit area with additional space.
- ❖ Company name posted on marquis as "Gold Level Patron" throughout conference activities.
- ❖ Verbal recognition during general session.

SILVER LEVEL: Unrestricted Educational Patron: \$1100

- ❖ Listed as distinguished "Silver Level Patron" in conference packet.
- ❖ Prime location in exhibit area with additional space.
- ❖ Company name posted on marquis as "Silver Level Patron" throughout conference activities.
- ❖ Verbal recognition during general session.

CONFERENCE FUNCTION SUPPORT

Support for the Dr Sam Heard Memorial Golf Tournament (\$1500)

Support of a hole - \$200.00 each (to cover prizes for tournament)

- ❖ Listed as "Golf Tournament supported by..." in conference packet and agenda.
- ❖ Company name posted on marquis at tournament.
- ❖ Distribution of company flyers/brochures (if available) at tournament.
- ❖ Supporter of a hole will have a sign of recognition at the hole during the tournament.

Support for Welcome Reception (\$1500)

- ❖ Listed as "Welcome Reception Supported by..." in conference packet and agenda.
- ❖ Company name posted on marquis during reception.
- ❖ Distribution of company flyers/brochures (if available) during reception.

Support for Continental Breakfast (four available @ \$750 each)

- ❖ Listed as "Breakfast Supported by..." in conference packet and agenda.
- ❖ Company name posted on marquis during breakfast.

Support for Morning Refreshment Break (three available @ \$350 each)

- ❖ Listed as "Break Supported by..." in conference packet and agenda.
- ❖ Company name posted on marquis during break.

Exhibitor/Display Fee \$800

- ❖ Listed as "Corporate Exhibitor" in conference packet.
- ❖ Participation for 2 representatives. Please include \$50.00 each for additional representatives to cover food for breaks and Welcome Reception.
- ❖ Draped table (30" by 6 ft.), two chairs, and identification badge. Table top displays are encouraged. Large displays that do not fit in the designated space or block other exhibitor displays are not acceptable. (Note: Please bring your own power strips & cords if needed – the conference center charges approx. \$7.50/day.)
- ❖ Conference packet.
- ❖ Complimentary list of attendee's following conference.

NOTE: Combinations of any of the above would be gladly accepted and appreciated.

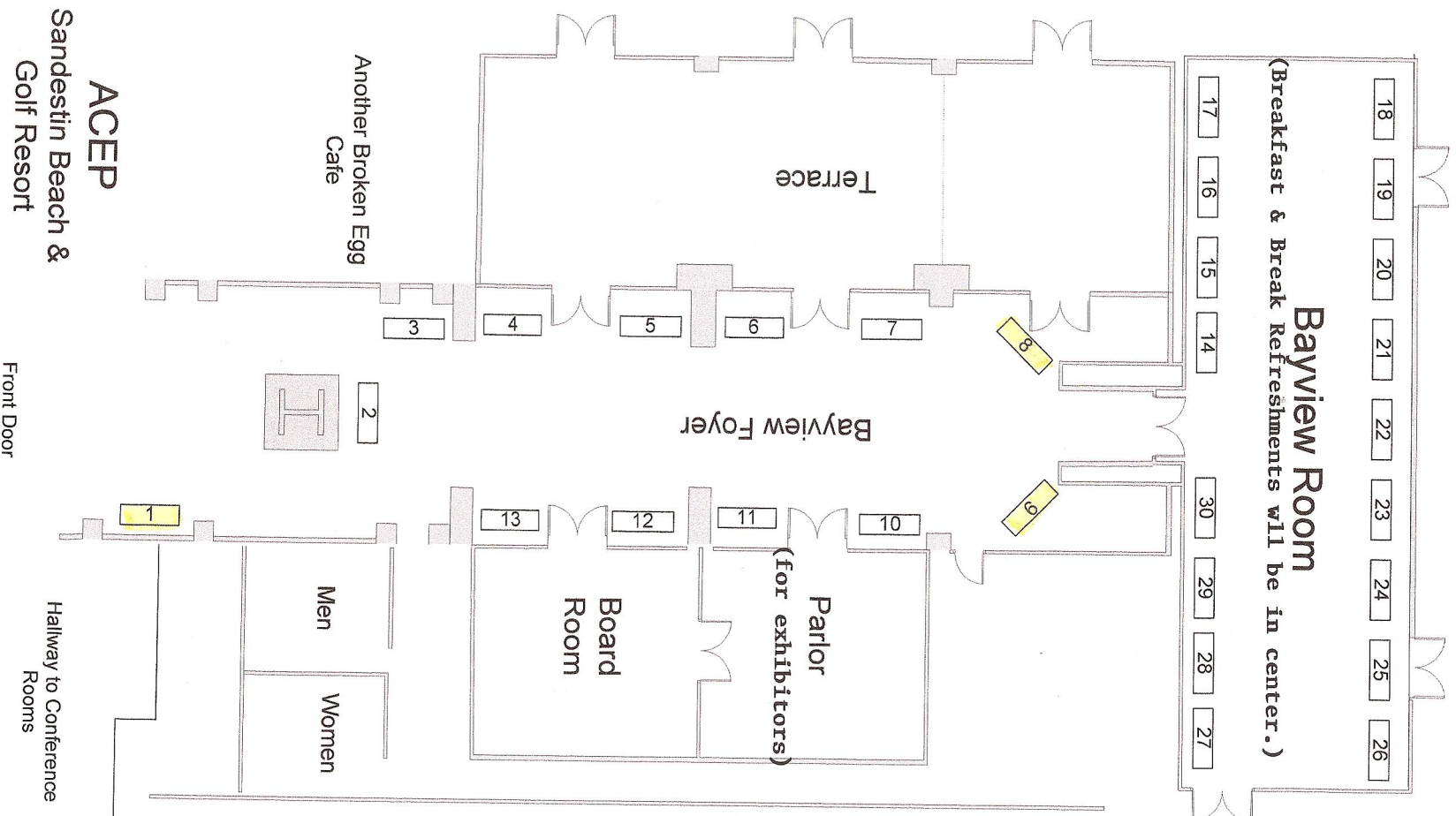

TABLES #1, #8, & #9 are for Platinum Level, Gold Level, or Silver Level Patrons. Reserve One Today!!

ACEP 2011
Sandestin Beach and Golf Resort
Grand Ballroom Foyer

